

MARK	REVISIONS NO	REASONABLE RVISIONS	DATE	DWN	APVD

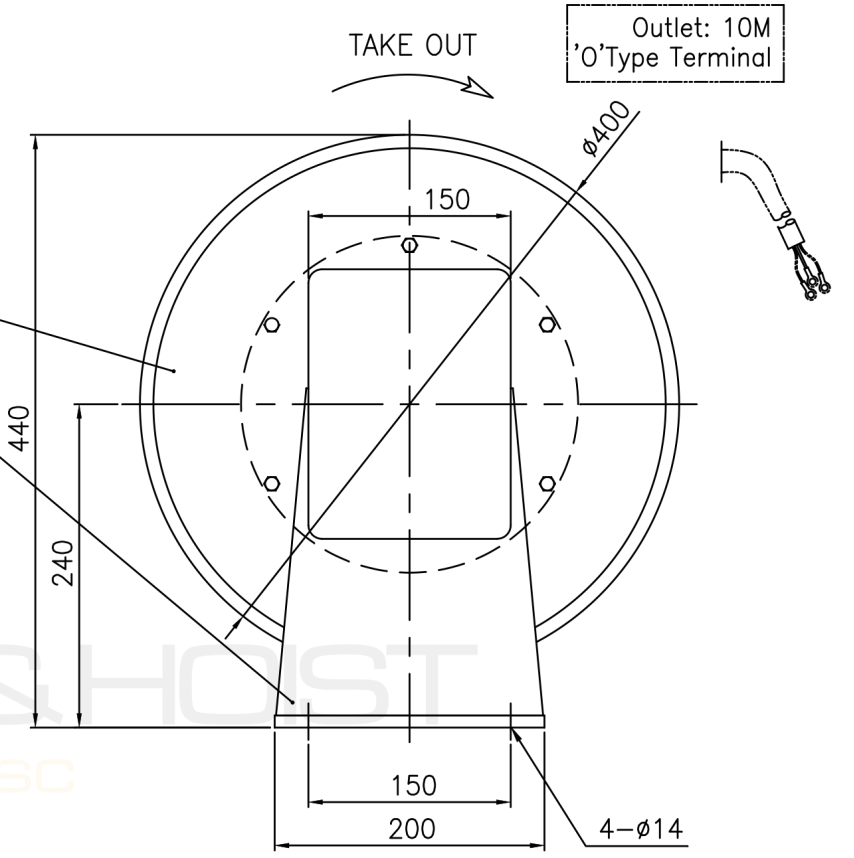
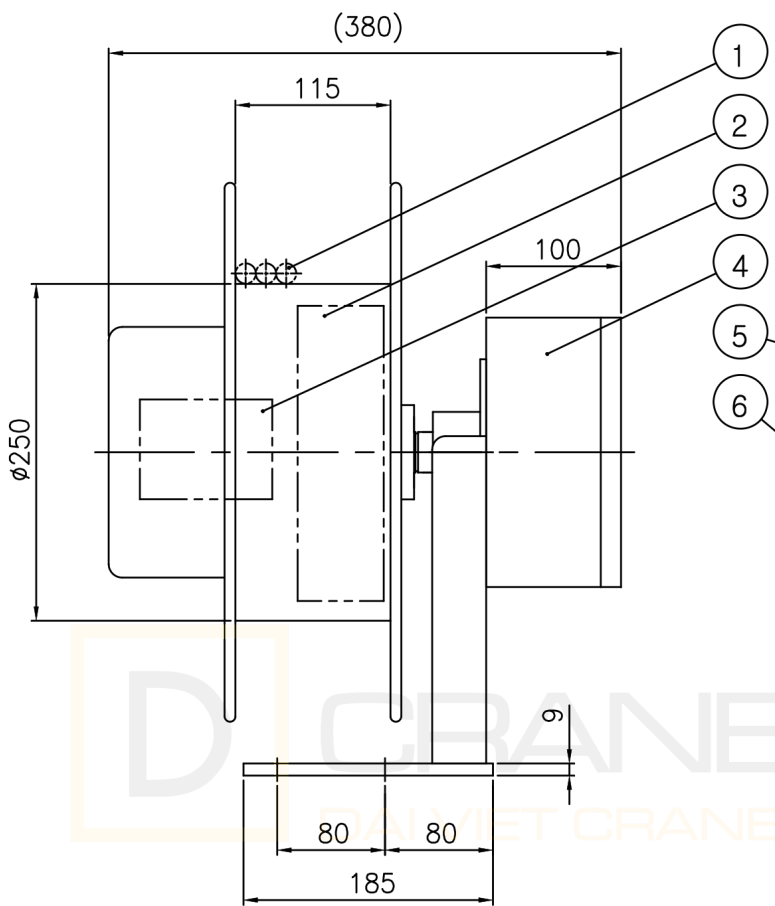
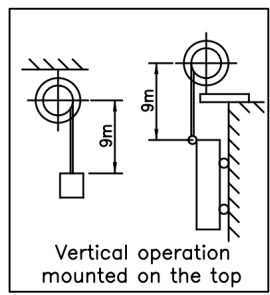
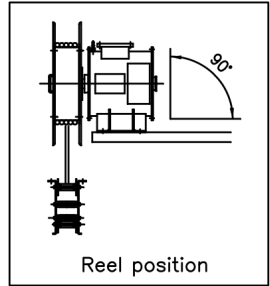
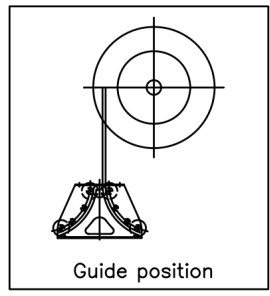

SPECIFICATION

- 1. Cable
 - o PNCT 2.5 sq x 4c
 - o Size : approx. 14 mm
 - o Weight : approx. 0.3 kg/m
 - o Length : 10 M
- 2. Winding Length : 9 M
- 3. Winding Speed : max. 20 M/MIN
- 4. Winding Torque : 3.5 Kg.m
- 5. Slip Ring : 20A x 4P
- 6. Paint Color : MUNSELL No. 7.5 BG6/1.5 (Out Door-60um)
- 7. Setting Height : Max. 9.0 m from G.L.
- 8. Q' ty : 1 Set

6		FRAME	SPHC	1	
5		DRUM	SPCC	2	
4		TERMINAL BOX	PLASTIC	1	
3		SLIP RING	C3771	4	
2		SPRING	ATX	2	
1		CABLE	PNCT	10M	
ITEM 순번	PARTS NO. 품번	PART NAME 품명	MATERIAL 재질	Q'TY 수량	REMARKS 비고
PROJECTION		DIMENSIONS		SCALE	MODEL
3rd ANGLE		METRIC (mm)		1 : 6	ECCV-210-4
CUSTOMER 고객		VNID		PART NAME	
MODEL COLOR 제품 색상		7.5 BG6/1.5		ASS'Y	
				PART NO.	
				Z840-4000	
SIGN		P.S.Y		 KOREEL CO., Ltd	
DATE		2017.3.23			